

Make Your Own Tilma

Materials

- Brown/tan art paper
 - *May also be done with brown paper bags
- Scissors
- Glue (not glue stick)
- Picture of Our Lady of Guadalupe (attached)
- Crayons/Markers
- Colored tissue paper cut into 1in squares
- Pencils

Directions for each tilma:

1. Cut 12in (for small children) or 15in (for larger children) wide strips from the paper roll
 - *Note: If using a brown paper bag, cut off the sides of the bag so as to create a flat paper for the tilma
2. Fold each strip in half along the short edge to form a 12in x 18in tilma
3. Sketch and cut out a 3.5in half-circle in the middle of the folded side of the tilma to create a head opening
 - *Note: The size of the half-circle should be adapted to accommodate the head of each child
 - *Note: Steps 1-3 should be completed in advance.
4. Have the children color in the image of Our Lady of Guadalupe
5. Cut out the finished picture of Guadalupe and glue it to the front of each tilma
6. Have children place glue dots where they would like 'flowers' on the tilma
7. Wrap a square of tissue paper around the bottom of a pencil (the eraser side)
8. With the wrapped pencil, place the tissue paper flower on the glue dot
9. Repeat steps 7-8 until all desired flowers are glued to the tilma
10. Once all flowers are glued on, let the tilma dry

Preparing the tilma:

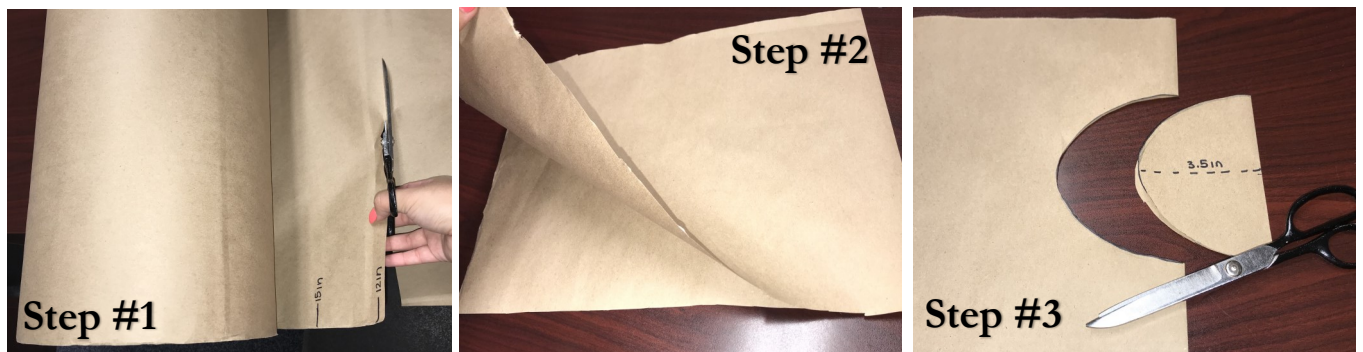

Save the Date—Walk With Mary

12 . 01 . 2018

Basilica of the National Shrine of the Immaculate Conception

For more details, please visit adw.org/media-events/events/walk-with-mary

Setting Guadalupe on the tilma:

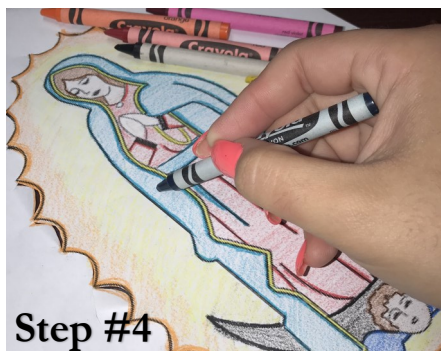

Adding the flowers to the tilma:



Remember to wear your tilma at the Walk with Mary!

Save the Date—Walk With Mary
12 . 01 . 2018
Basilica of the National Shrine of the Immaculate Conception

For more details, please visit adw.org/media-events/events/walk-with-mary